

## 珠巢型

Needle roller and cage assemblies

引擎連桿用一小端部  
For connecting rod applications  
-for small end

KVE

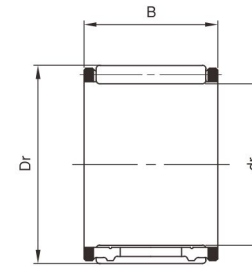

KVE...M

KVE  
KVE...M

KVE

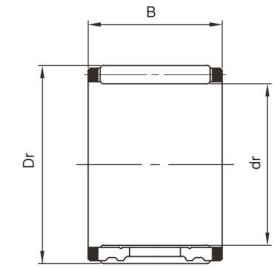

KVE...M

配合軸徑 Suitable diameter	軸承型號 Series	單位重 Weight	基本額定負荷 Basic load ratings	
			動 Dynamic C kgf	靜 Static Co kgf
mm	K dr X Dr X B	g		
8	KVE 8X11X10	1.9	340	330
	KVE 8X11X12	2.1	420	430
	KVE 8X11X13	2.5	490	530
	KVE 8X12X10	3	470	420
9	KVE 9X12X11.5	2.1	450	490
	KVE 9X13X12.5	3	620	620
10	KVE 10X13X12.5	3	520	610
	KVE 10X13X14	3.1	560	670
	KVE 10X13X16	4.5	600	730
	KVE 10X14X10	3.8	460	430
	KVE 10X14X11SM	4.1	550	550
	KVE 10X14X12.5M	4.8	620	630
	KVE 10X14X13M	5	620	630
	KVE 10X14X14.5	5.1	670	700
	KVE 10X14X15	5	620	630
	KVE 10X17X13	7	730	570

(1)除了標準的型號之外，SYI亦接受訂製特殊的尺寸規格，特殊型號標示為K drXDrXB例如K 20X26X15.

Other than the series shown above, custom-made orders are available according to the series number K drXDrXB.

配合軸徑 Suitable diameter	軸承型號 Series	單位重 Weight	基本額定負荷 Basic load ratings	
			動 Dynamic C kgf	靜 Static Co kgf
mm	K dr X Dr X B	g		
11	KVE 11X15X12	5.1	620	640
	KVE 11X15X12.5S	5.1	620	640
12	KVE 12X15X14.5M	3.9	580	740
	KVE 12X15X15M	4	580	740
	KVE 12X15X15SM	4	580	740
	KVE 12X15X16.5M	6.5	670	880
	KVE 12X16X13M	5.6	660	720
	KVE 12X16X15M	6.1	760	860
	KVE 12X16X16	6.8	880	1040
	KVE 12X16X20	7	970	1180
	KVE 12X17X13	6.5	780	780
	KVE 12X17X14M	7	920	960
13	KVE 12X17X14.5	8	920	960
	KVE 12X17X15M	8.5	940	860
	KVE 13X16X14M	6.8	570	740
	KVE 13X17X15	5	810	960

## 珠巢型

Needle roller and cage assemblies

引擎連桿用一小端部  
For connecting rod applications  
-for small end

KVE

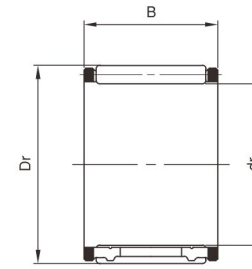

KVE...M

KVE  
KVE...M

KVE

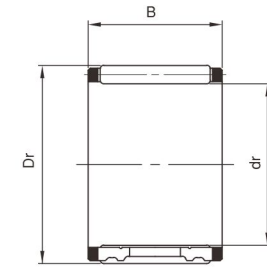

KVE...M

配合軸徑 Suitable diameter	軸承型號 Series	單位重 Weight	基本額定負荷 Basic load ratings	
			動 Dynamic C kgf	靜 Static Co kgf
mm	K dr X Dr X B	g		
13	KVE 13X18X14.5	8.2	1040	1150
	KVE 14X18X14.5	6.5	800	960
	KVE 14X18X16	7.3	910	1150
	KVE 14X18X16.5	7.4	980	1250
	KVE 14X18X17	7.5	920	1150
	KVE 14X18X19M	7.7	1030	1340
	KVE 14X18X20M	8	990	1250
	KVE 14X19X17.1M	9.5	1130	1290
14	KVE 15X19X8	4.3	540	590
	KVE 15X19X13	6.2	780	960
	KVE 15X19X17S	8	970	1260
	KVE 15X19X19M	8.7	1030	1360
	KVE 15X19X19.7M	8.9	1090	1460
	KVE 15X19X20SM	9	1150	1580
	KVE 15X20X18SM	8.7	1270	1530
	KVE 15X20X20SM	9	1330	1640

(1)除了標準的型號之外，SYI亦接受訂製特殊的尺寸規格，特殊型號標示為K drXDrXB例如K 20X26X15.

Other than the series shown above, custom-made orders are available according to the series number K drXDrXB.

配合軸徑 Suitable diameter	軸承型號 Series	單位重 Weight	基本額定負荷 Basic load ratings	
			動 Dynamic C kgf	靜 Static Co kgf
mm	K dr X Dr X B	g		
16	KVE 16X20X17.5M	8.7	970	1280
	KVE 16X20X19M	9	1090	1480
	KVE 16X20X19.5M	9.5	1030	1380
	KVE 16X20X22.5M	10	1030	1370
	KVE 16X20X23	11	1080	1460
	KVE 16X21X18	12	1320	1650
	KVE 16X21X19.5M	13	1400	1770
	KVE 16X21X22.5M	13	1560	2040
	KVE 16X21X22.5SM	13	1410	1780
	KVE 16X21X22.5SM	13	1410	1780
17	KVE 17X21X10	5.5	730	910
	KVE 17X21X27	9.3	1630	2540
18	KVE 18X22X16	9.2	1060	1480
	KVE 18X22X20M	10	1130	1610
	KVE 18X22X22SM	12	1270	1850
	KVE 18X22X24SM	14	1310	1940
	KVE 18X23X22M	16	1480	1960

## 珠巢型

Needle roller and cage assemblies

引擎連桿用一小端部  
For connecting rod applications  
-for small end

KVE

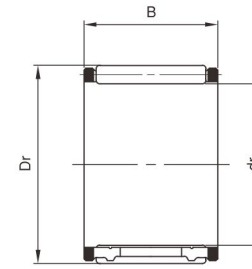

KVE...M

KVE  
KVE...M

KVE

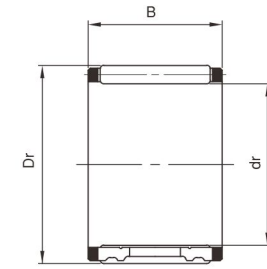

KVE...M

配合軸徑 Suitable diameter	軸承型號 Series	單位重 Weight	基本額定負荷 Basic load ratings	
			動 Dynamic C kgf	靜 Static Co kgf
mm	K dr X Dr X B	g		
18	KVE 18X23X22SM	16	1480	1960
	KVE 18X23X24	18	1610	2190
19	KVE 19X24X25	23	1740	2460
	KVE 19.05X23.81X28.5SM	20	1980	3000
20	KVE 20X24X23SM	14.5	1430	2250
	KVE 20X24X24SM	15	1430	2250
	KVE 20X25X22SM	18	1690	2400
	KVE 20X25X24SM	21	1680	2380
	KVE 20X25X25SM	22	2050	3080
	KVE 20X25X29M	25	2150	3280
	KVE 20X26X24S	24	2140	2890
21	KVE 21X25X24SM	18	1550	2540
	KVE 21X27X25SM	24	2060	2800
22	KVE 22X27X23SM	22	2030	3130
	KVE 22X27X24S	24	2100	3280
	KVE 22X27X25SM	25	2030	3130

(1)除了標準的型號之外，SYI亦接受訂製特殊的尺寸規格，特殊型號標示為K drXDrXB例如K 20X26X15.

Other than the series shown above, custom-made orders are available according to the series number K drXDrXB.

配合軸徑 Suitable diameter	軸承型號 Series	單位重 Weight	基本額定負荷 Basic load ratings	
			動 Dynamic C kgf	靜 Static Co kgf
mm	K dr X Dr X B	g		
22	KVE 23.07X28.07X21.5	22	1900	2930
	KVE 24X29X24S	25	2170	3490
24	KVE 24X29X25S	26	2170	3490
	KVE 24X29X26SM	27	2170	3490
	KVE 24X29X28.5SM	29	2070	3290
25	KVE 25X29X12.8	13.1	1080	1700
	KVE 25X29X17	13	1520	2460
	KVE 25X30X13	13.1	1320	1880
26	KVE 26X30X12.8	10.5	1100	1710
	KVE 26X31X24W	30	2140	3540
	KVE 26X31X26.5S	26	2480	4295
28	KVE 28X32X17	25	1530	2770