

車削型

Needle Roller Bearings

標準式_無內輪

With ribs-without inner ring

NK

NKS

RNA 49

RNA 59

RNA 69



NK(dr≤10)

NK (dr≥12)
NKS ,RNA 49 ,RNA 59
RNA 69 (dr≤35)

RNA 69 (dr≥40)

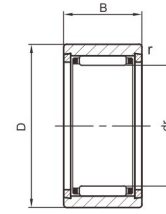
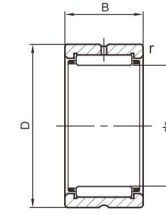
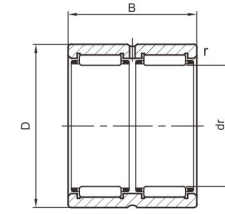
NK ,NKS
(dr≤10mm)NK (dr≥12)
NKS ,RNA 49 ,RNA 59
RNA 69 (dr≤35)
single rowRNA 69
(dr≥40mm)
double row

軸徑 Shaft dia.	軸承型號 Series					單位重 Weight	
	mm	NK	NKS	RNA 49	RNA 59		RNA 69
9		NK 9/12					10
		NK 9/16					13.2
10		NK 10/12					10.7
		NK 10/16					14.3
12		NK 12/12					12.2
		NK 12/16					16.3
14				RNA 4900			16.5
		NK 14/16					21
		NK 14/20					26.5
15		NK 15/16					22.5
		NK 15/20					28
16				RNA 4901			18.1
		NK 16/16					23
		NK 16/20					29
						RNA 6901	30

(1)除了標準的型號之外,SYI亦接受訂製特殊的尺寸規格,特殊型號標示為NK dr x D x B例如NK15x23x12.
Other than the series shown above, custom-made orders are available according to the series number NK dr x D x B.

(2)當使用油脂潤滑時,極限回轉速為表列數值的60%.
With grease lubrication, 60% of the values given in the tables are permissible.

尺寸 Dimensions mm				基本額定負荷 Basic load ratings		極限回轉速 Limited Speed
dr	D	B	r	動 Dynamic C	靜 Static Co	機油潤滑 Oil rpm (2)
			min.	kgf	kgf	
9	16	12	0.3	570	560	30000
9	16	16	0.3	780	840	30000
10	17	12	0.3	390	420	28000
10	17	16	0.3	840	950	28000
12	19	12	0.3	640	690	26000
12	19	16	0.3	880	1040	26000
14	22	13	0.3	960	1050	24000
14	22	16	0.3	1130	1290	24000
14	22	20	0.3	1430	1750	24000
15	23	16	0.3	1190	1410	23000
15	23	20	0.3	1500	1910	23000
16	24	13	0.3	1000	1160	23000
16	24	16	0.3	1250	1540	23000
16	24	20	0.3	1580	2080	23000
16	24	22	0.3	1970	2950	23000

(3)外徑尺寸 > 100mm以上者,需經濟批量訂購生產。
The out dimensions > 100mm are produced by order.

(4)NKS 系列產品,需經濟批量訂購生產。
NKS series are produced by order.

車削型

Needle Roller Bearings

標準式_無內輪

With ribs-without inner ring

NK

NKS

RNA 49

RNA 59

RNA 69



NK(dr≤10)

NK (dr≥12)
NKS ,RNA 49 ,RNA 59
RNA 69 (dr≤35)

RNA 69 (dr≥40)

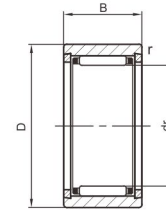
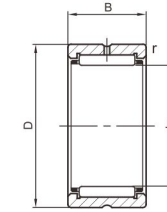
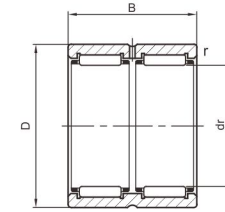
NK ,NKS
(dr≤10mm)NK (dr≥12)
NKS ,RNA 49 ,RNA 59
RNA 69 (dr≤35)
single rowRNA 69
(dr≥40mm)
double row

軸徑 Shaft dia.	軸承型號 Series					單位重 Weight
	mm	NK	NKS	RNA 49	RNA 59	
17	NK 17/16					24.5
	NK 17/20					30.5
18	NK 18/16					25.5
	NK 18/20					32
19	NK 19/16					27
	NK 19/20					34
20			RNA 4902			21.5
	NK 20/16					27.5
				RNA 5902		33
	NK 20/20					35.5
					RNA 6902	37
		NKS 20				48.7
21	NK 21/16					29
	NK 21/20					36

(1)除了標準的型號之外,SYI亦接受訂製特殊的尺寸規格,特殊型號標示為NK dr x D x B例如NK15x23x12.
Other than the series shown above, custom-made orders are available according to the series number NK dr x D x B.

(2)當使用油脂潤滑時,極限回轉速為表列數值的60%.
With grease lubrication, 60% of the values given in the tables are permissible.

尺寸 Dimensions mm				基本額定負荷 Basic load ratings		極限回轉速 Limited Speed
dr	D	B	r	動 Dynamic C kgf	靜 Static Co kgf	機油潤滑 Oil rpm (2)
17	25	16	0.3	1300	1660	22000
17	25	20	0.3	1650	2250	22000
18	26	16	0.3	1370	1780	21000
18	26	20	0.3	1730	2410	21000
19	27	16	0.3	1420	1910	21000
19	27	20	0.3	1790	2580	21000
20	28	13	0.3	1130	1440	20000
20	28	16	0.3	1420	1920	20000
20	28	18	0.3	1620	2290	20000
20	28	20	0.3	1970	2600	20000
20	28	23	0.3	1760	2950	20000
20	32	20	0.6	2030	2460	20000
21	29	16	0.3	1460	2040	19000
21	29	20	0.3	1840	2760	19000

(3)外徑尺寸 > 100mm以上者,需經濟批量訂購生產。
The out dimensions > 100mm are produced by order.

(4)NKS 系列產品, 需經濟批量訂購生產。
NKS series are produced by order.

車削型

Needle Roller Bearings

標準式_無內輪

With ribs-without inner ring

NK

NKS

RNA 49

RNA 59

RNA 69

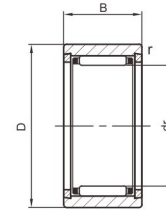
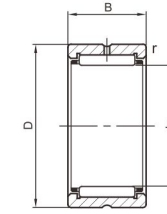
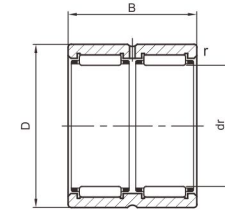
NK($dr \leq 10$)NK ($dr \geq 12$)
NKS ,RNA 49 ,RNA 59
RNA 69 ($dr \leq 35$)RNA 69 ($dr \geq 40$)NK ,NKS
($dr \leq 10mm$)NK ($dr \geq 12$)
NKS ,RNA 49 ,RNA 59
RNA 69 ($dr \leq 35$)
single rowRNA 69
($dr \geq 40mm$)
double row

軸徑 Shaft dia.	軸承型號 Series					單位重 Weight	
	mm	NK	NKS	RNA 49	RNA 59		RNA 69
22				RNA 4903			23.5
		NK 22/16					30
					RNA 5903		35
		NK 22/20					37.5
						RNA 6903	40.5
			NKS 22				61.5
24		NK 24/16					32
		NK 24/20					40.5
			NKS 24				65.5
25		NK 25/16					33.5
		NK 25/20					42
				RNA 4904			55.5
					RNA 5904		84
						RNA 6904	95.5
			NKS 25				68.1

(1)除了標準的型號之外,SYI亦接受訂製特殊的尺寸規格,特殊型號標示為NK dr x D x B例如NK15x23x12.
Other than the series shown above, custom-made orders are available according to the series number NK dr x D x B.

(2)當使用油脂潤滑時,極限回轉速為表列數值的60%.
With grease lubrication, 60% of the values given in the tables are permissible.

尺寸 Dimensions mm				基本額定負荷 Basic load ratings		極限回轉速 Limited Speed
dr	D	B	r	動 Dynamic C	靜 Static Co	機油潤滑 Oil
			min.	kgf	kgf	rpm (2)
22	30	13	0.3	1220	1630	18000
22	30	16	0.3	1520	2160	18000
22	30	18	0.3	1640	2400	18000
22	30	20	0.3	1920	2930	18000
22	30	23	0.3	2120	3340	18000
22	35	20	0.3	2510	3020	18000
24	32	16	0.3	1550	2300	17000
24	32	20	0.3	1960	3110	17000
24	37	20	0.3	2640	3300	17000
25	33	16	0.3	1610	2420	16000
25	33	20	0.3	2040	3280	16000
25	37	17	0.6	2210	2670	16000
25	37	23	0.3	3050	4050	16000
25	37	30	0.3	3470	4780	16000
25	38	20	0.3	2620	3320	16000

(3)外徑尺寸 > 100mm以上者,需經濟批量訂購生產。
The out dimensions > 100mm are produced by order.

(4)NKS 系列產品, 需經濟批量訂購生產。
NKS series are produced by order.

車削型

Needle Roller Bearings

標準式_無內輪

With ribs-without inner ring

NK

NKS

RNA 49

RNA 59

RNA 69



NK (dr ≤ 10)

NK (dr ≥ 12)
NKS, RNA 49, RNA 59
RNA 69 (dr ≤ 35)

RNA 69 (dr ≥ 40)

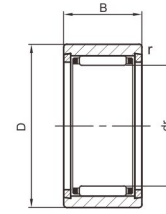
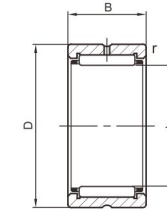
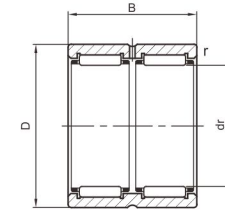
NK, NKS
(dr ≤ 10mm)NK (dr ≥ 12)
NKS, RNA 49, RNA 59
RNA 69 (dr ≤ 35)
single rowRNA 69
(dr ≥ 40mm)
double row

軸徑 Shaft dia.	軸承型號 Series					單位重 Weight		
	mm	NK	NKS	RNA 49	RNA 59		RNA 69	g
26		NK 26/16					34.5	
		NK 26/20					43.5	
28		NK 28/20					51.5	
		NK 28/30					83.5	
				RNA 49/22			56.5	
					RNA 59/22		92	
						RNA 69/22		97.5
			NKS 28				83.6	
29		NK 29/20					57	
		NK 29/30					85	

(1)除了標準的型號之外,SYI亦接受訂製特殊的尺寸規格,特殊型號標示為NK dr x D x B例如NK15x23x12.
Other than the series shown above, custom-made orders are available according to the series number NK dr x D x B.

(2)當使用油脂潤滑時,極限回轉速為表列數值的60%.
With grease lubrication, 60% of the values given in the tables are permissible.

尺寸 Dimensions mm				基本額定負荷 Basic load ratings		極限回轉速 Limited Speed
dr	D	B	r	動 Dynamic C kgf	靜 Static Co kgf	機油潤滑 Oil rpm (2)
26	34	16	0.3	1630	2550	15000
26	34	20	0.3	2070	3450	15000
28	37	20	0.3	2140	3630	14000
28	37	30	0.3	3060	5760	14000
28	39	17	0.3	2270	3090	14000
28	39	23	0.3	2980	4440	14000
28	39	30	0.3	3380	5180	14000
28	42	20	0.6	2970	3730	14000
29	38	20	0.3	2150	3790	14000
29	38	30	0.3	3080	6030	14000

(3)外徑尺寸 > 100mm以上者,需經濟批量訂購生產。
The out dimensions > 100mm are produced by order.

(4)NKS 系列產品, 需經濟批量訂購生產。
NKS series are produced by order.

車削型

Needle Roller Bearings

標準式_無內輪

With ribs-without inner ring

NK

NKS

RNA 49

RNA 59

RNA 69



NK(dr≤10)

NK (dr≥12)
NKS ,RNA 49 ,RNA 59
RNA 69 (dr≤35)

RNA 69 (dr≥40)

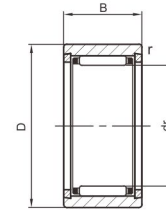
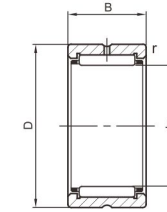
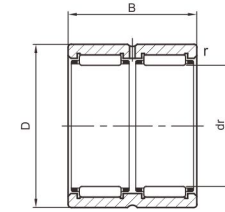
NK ,NKS
(dr≤10mm)NK (dr≥12)
NKS ,RNA 49 ,RNA 59
RNA 69 (dr≤35)
single rowRNA 69
(dr≥40mm)
double row

軸徑 Shaft dia.	軸承型號 Series					單位重 Weight	
	mm	NK	NKS	RNA 49	RNA 59		RNA 69
30		NK 30/20					64.5
		NK 30/30					97.5
				RNA 4905			64
					RNA 5905		101
						RNA 6905	101
			NKS 30				104
32		NK 32/20					68
		NK 32/30					102
				RNA 49/28			76.5
					RNA 59/28		108
						RNA 69/28	133
			NKS 32				110

(1)除了標準的型號之外,SYI亦接受訂製特殊的尺寸規格,特殊型號標示為NK dr x D x B例如NK15x23x12.
Other than the series shown above, custom-made orders are available according to the series number NK dr x D x B.

(2)當使用油脂潤滑時,極限回轉速為表列數值的60%.
With grease lubrication, 60% of the values given in the tables are permissible.

尺寸 Dimensions mm				基本額定負荷 Basic load ratings		極限回轉速 Limited Speed
dr	D	B	r	動 Dynamic C	靜 Static Co	機油潤滑 Oil rpm (2)
			min.	kgf	kgf	
30	40	20	0.3	2480	3930	13000
30	40	30	0.3	3550	6250	13000
30	42	17	0.3	2510	3310	13000
30	42	23	0.3	3300	4700	13000
30	42	30	0.3	3740	5550	13000
30	45	22	0.6	3520	4390	13000
32	42	20	0.3	2510	4150	13000
32	42	30	0.3	3600	6580	13000
32	45	17	0.3	2610	3530	13000
32	45	23	0.3	3420	5010	13000
32	45	30	0.3	3910	5920	13000
32	47	22	0.6	3680	4750	13000

(3)外徑尺寸 > 100mm以上者,需經濟批量訂購生產。
The out dimensions > 100mm are produced by order.

(4)NKS 系列產品, 需經濟批量訂購生產。
NKS series are produced by order.

車削型

Needle Roller Bearings

標準式_無內輪

With ribs-without inner ring

NK

NKS

RNA 49

RNA 59

RNA 69

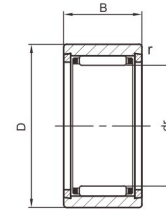
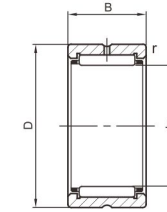
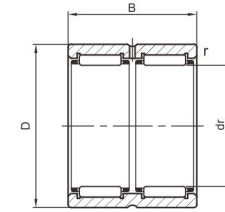
NK($dr \leq 10$)NK ($dr \geq 12$)
NKS ,RNA 49 ,RNA 59
RNA 69 ($dr \leq 35$)RNA 69 ($dr \geq 40$)NK ,NKS
($dr \leq 10\text{mm}$)NK ($dr \geq 12$)
NKS ,RNA 49 ,RNA 59
RNA 69 ($dr \leq 35$)
single rowRNA 69
($dr \geq 40\text{mm}$)
double row

軸徑 Shaft dia.	軸承型號 Series					單位重 Weight	
	mm	NK	NKS	RNA 49	RNA 59		RNA 69
35	NK 35/20					73.5	
	NK 35/30					112	
				RNA 4906		72.5	
					RNA 5906	108	
						RNA 6906	125
			NKS 35			118	
	37	NK 37/20					77.5
NK 37/30						117	
			NKS 37			123	
38	NK 38/20					79	
	NK 38/30					119	

(1)除了標準的型號之外,SYI亦接受訂製特殊的尺寸規格,特殊型號標示為NK dr x D x B例如NK15x23x12.
Other than the series shown above, custom-made orders are available according to the series number NK dr x D x B.

(2)當使用油脂潤滑時,極限回轉速為表列數值的60%.
With grease lubrication, 60% of the values given in the tables are permissible.

尺寸 Dimensions mm				基本額定負荷 Basic load ratings		極限回轉速 Limited Speed
dr	D	B	r	動 Dynamic C kgf	靜 Static Co kgf	機油潤滑 Oil rpm (2)
			min.			
35	45	20	0.3	2540	4370	11000
35	45	30	0.3	3630	6930	11000
35	47	17	0.3	2680	3770	11000
35	47	23	0.3	3520	5340	11000
35	47	30	0.3	4370	7060	11000
35	50	22	0.6	3830	5120	11000
37	47	20	0.3	2620	4580	11000
37	47	30	0.3	3750	7270	11000
37	52	22	0.6	4140	5800	11000
38	48	20	0.3	2700	4780	11000
38	48	30	0.3	3870	7580	11000

(3)外徑尺寸 > 100mm以上者,需經濟批量訂購生產。
The out dimensions > 100mm are produced by order.

(4)NKS 系列產品,需經濟批量訂購生產。
NKS series are produced by order.

車削型

Needle Roller Bearings

標準式_無內輪

With ribs-without inner ring

NK

NKS

RNA 49

RNA 59

RNA 69



NK(dr≤10)

NK (dr≥12)
NKS ,RNA 49 ,RNA 59
RNA 69 (dr≤35)

RNA 69 (dr≥40)

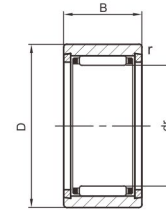
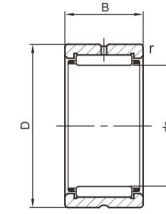
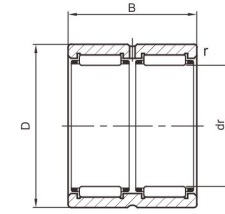
NK ,NKS
(dr≤10mm)NK (dr≥12)
NKS ,RNA 49 ,RNA 59
RNA 69 (dr≤35)
single rowRNA 69
(dr≥40mm)
double row

軸徑 Shaft dia.	軸承型號 Series					單位重 Weight	
	mm	NK	NKS	RNA 49	RNA 59		RNA 69
40	NK 40/20					83	
	NK 40/30					125	
				RNA 49/32		96	
					RNA 59/32	149	
						RNA 69/32	172
			NKS 40				129
42	NK 42/20					86.5	
	NK 42/30					130	
				RNA 4907		113	
					RNA 5907	176	
						RNA 6907	200
43	NK 43/20					88.5	
	NK 43/30					133	
			NKS 43			139	

(1)除了標準的型號之外,SYI亦接受訂製特殊的尺寸規格,特殊型號標示為NK dr x D x B例如NK15x23x12.
Other than the series shown above, custom-made orders are available according to the series number NK dr x D x B.

(2)當使用油脂潤滑時,極限回轉速為表列數值的60%.
With grease lubrication, 60% of the values given in the tables are permissible.

尺寸 Dimensions mm				基本額定負荷 Basic load ratings		極限回轉速 Limited Speed
dr	D	B	r	動 Dynamic C	靜 Static Co	機油潤滑 Oil rpm (2)
			min.	kgf	kgf	
40	50	20	0.3	2700	4980	10000
40	50	30	0.3	3870	7920	10000
40	52	20	0.6	3130	4780	10000
40	52	27	0.6	4040	6620	10000
40	52	36	0.6	5370	9550	10000
40	55	22	0.6	4100	5800	10000
42	52	20	0.3	2780	5190	9500
42	52	30	0.3	3980	8250	9500
42	55	20	0.6	3180	5020	9500
42	55	27	0.6	4580	7550	9500
42	55	36	0.6	5270	9600	9500
43	53	20	0.3	2850	5390	9500
43	53	30	0.3	4090	8570	9500
43	58	22	0.6	4200	6150	9500

(3)外徑尺寸 > 100mm以上者,需經濟批量訂購生產。
The out dimensions > 100mm are produced by order.

(4)NKS 系列產品, 需經濟批量訂購生產。
NKS series are produced by order.

車削型

Needle Roller Bearings

標準式_無內輪

With ribs-without inner ring

NK

NKS

RNA 49

RNA 59

RNA 69



NK(dr≤10)

NK (dr≥12)
NKS ,RNA 49 ,RNA 59
RNA 69 (dr≤35)

RNA 69 (dr≥40)

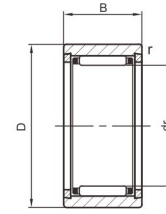
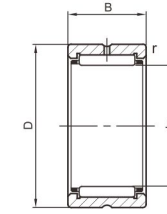
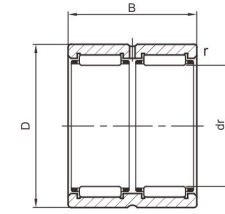
NK ,NKS
(dr≤10mm)NK (dr≥12)
NKS ,RNA 49 ,RNA 59
RNA 69 (dr≤35)
single rowRNA 69
(dr≥40mm)
double row

軸徑 Shaft dia.	軸承型號 Series					單位重 Weight	
	mm	NK	NKS	RNA 49	RNA 59		RNA 69
45		NK 45/20					92
		NK 45/30					138
				RNA 49/38			120
			NKS 45				145
47		NK 47/20					95
		NK 47/30					144
48				RNA 4908			152
					RNA 5908		225
						RNA 6908	275
50		NK 50/25					159
		NK 50/35					225
			NKS 50				157
52				RNA 4909			197
					RNA 5909		232
						RNA 6909	355

(1)除了標準的型號之外,SYI亦接受訂製特殊的尺寸規格,特殊型號標示為NK dr x D x B例如NK15x23x12.
Other than the series shown above, custom-made orders are available according to the series number NK dr x D x B.

(2)當使用油脂潤滑時,極限回轉速為表列數值的60%.
With grease lubrication, 60% of the values given in the tables are permissible.

尺寸 Dimensions mm				基本額定負荷 Basic load ratings		極限回轉速 Limited Speed
dr	D	B	r	動 Dynamic C kgf	靜 Static Co kgf	機油潤滑 Oil rpm (2)
			min.			
45	55	20	0.3	2930	5600	9000
45	55	30	0.3	4200	8900	9000
45	58	20	0.6	5800	5480	9000
45	60	22	0.6	4360	6490	9000
47	57	20	0.3	3230	6390	8500
47	57	30	0.3	4630	10200	8500
48	62	22	0.6	4150	6780	8500
48	62	30	0.6	5800	10340	8500
48	62	40	0.6	6320	11600	8500
50	62	25	0.6	4140	8220	8000
50	62	35	0.6	5700	12400	8000
50	65	22	1	4590	7180	8000
52	68	22	0.6	4170	7110	7500
52	68	30	0.6	6080	11280	7500
52	68	40	0.6	6790	13300	7500

(3)外徑尺寸 > 100mm以上者,需經濟批量訂購生產。
The out dimensions > 100mm are produced by order.

(4)NKS 系列產品, 需經濟批量訂購生產。
NKS series are produced by order.

車削型

Needle Roller Bearings

標準式_無內輪

With ribs-without inner ring

NK

NKS

RNA 49

RNA 59

RNA 69



NK(dr≤10)

NK (dr≥12)
NKS ,RNA 49 ,RNA 59
RNA 69 (dr≤35)

RNA 69 (dr≥40)

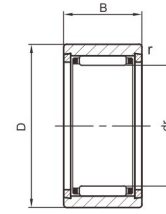
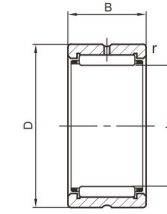
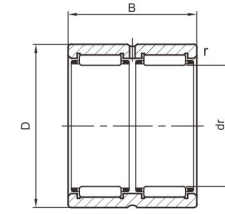
NK ,NKS
(dr≤10mm)NK (dr≥12)
NKS ,RNA 49 ,RNA 59
RNA 69 (dr≤35)
single rowRNA 69
(dr≥40mm)
double row

軸徑 Shaft dia.	軸承型號 Series					單位重 Weight	
	mm	NK	NKS	RNA 49	RNA 59		RNA 69
55		NK 55/25					193
		NK 55/35					255
			NKS 55				221
58				RNA 4910			179
					RNA 5910		289
						RNA 6910	320
60		NK 60/25					187
		NK 60/35					260
			NKS 60				335
63				RNA 4911			265
					RNA 5911		367
						RNA 6911	475
65		NK 65/25					225
		NK 65/35					315
			NKS 65				356

(1)除了標準的型號之外,SYI亦接受訂製特殊的尺寸規格,特殊型號標示為NK dr x D x B例如NK15x23x12.
Other than the series shown above, custom-made orders are available according to the series number NK dr x D x B.

(2)當使用油脂潤滑時,極限回轉速為表列數值的60%.
With grease lubrication, 60% of the values given in the tables are permissible.

尺寸 Dimensions mm				基本額定負荷 Basic load ratings		極限回轉速 Limited Speed
dr	D	B	r	動 Dynamic C kgf	靜 Static Co kgf	機油潤滑 Oil rpm (2)
			min.			
55	68	25	0.6	4200	8840	7500
55	68	35	0.6	5770	13300	7500
55	72	22	1	5160	8050	7500
58	72	22	0.6	4590	8130	7000
58	72	30	0.6	6340	12200	7000
58	72	40	0.6	7520	15200	7000
60	72	25	0.6	4790	10600	6500
60	72	35	0.6	6590	16000	6500
60	80	28	1.1	6950	11400	6500
63	80	25	1	6010	10200	6500
63	80	34	1	8290	15500	6500
63	80	45	1	9890	19400	6500
65	78	25	0.6	5080	11500	6000
65	78	35	0.6	6990	17400	6000
65	85	28	1.1	7040	12000	6000

(3)外徑尺寸 > 100mm以上者,需經濟批量訂購生產。
The out dimensions > 100mm are produced by order.

(4)NKS 系列產品,需經濟批量訂購生產。
NKS series are produced by order.

車削型

Needle Roller Bearings

標準式_無內輪

With ribs-without inner ring

NK

NKS

RNA 49

RNA 59

RNA 69



NK(dr≤10)

NK (dr≥12)
NKS ,RNA 49 ,RNA 59
RNA 69 (dr≤35)

RNA 69 (dr≥40)

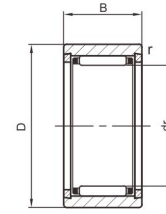
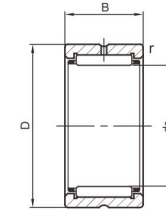
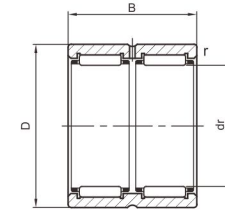
NK ,NKS
(dr≤10mm)NK (dr≥12)
NKS ,RNA 49 ,RNA 59
RNA 69 (dr≤35)
single rowRNA 69
(dr≥40mm)
double row

軸徑 Shaft dia.	軸承型號 Series					單位重 Weight	
	mm	NK	NKS	RNA 49	RNA 59		RNA 69
68		NK 68/25					250
		NK 68/35					350
				RNA 4912			285
					RNA 5912		408
						RNA 6912	510
70		NK 70/25					280
		NK 70/35					395
			NKS 70				380
72				RNA 4913			325
					RNA 5913		462
						RNA 6913	585
73		NK 73/25					335
		NK 73/35					475

(1)除了標準的型號之外,SYI亦接受訂製特殊的尺寸規格,特殊型號標示為NK dr x D x B例如NK15x23x12.
Other than the series shown above, custom-made orders are available according to the series number NK dr x D x B.

(2)當使用油脂潤滑時,極限回轉速為表列數值的60%.
With grease lubrication, 60% of the values given in the tables are permissible.

尺寸 Dimensions mm				基本額定負荷 Basic load ratings		極限回轉速 Limited Speed
dr	D	B	r	動 Dynamic C kgf	靜 Static Co kgf	機油潤滑 Oil rpm (2)
			min.			
68	82	25	0.6	5530	12100	6000
68	82	35	0.6	7650	18400	6000
68	85	25	1	6120	10700	6000
68	85	34	1	8420	16200	6000
68	85	45	1	10100	20900	6000
70	85	25	0.6	6110	12500	5500
70	85	35	0.6	8460	18900	5500
70	90	28	1.1	7290	13100	5500
72	90	25	1	6750	11700	5500
72	90	34	1	9280	17700	5500
72	90	45	1	10800	21900	5500
73	90	25	1	6150	13200	5500
73	90	35	1	8510	20100	5500

(3)外徑尺寸 > 100mm以上者,需經濟批量訂購生產。
The out dimensions > 100mm are produced by order.

(4)NKS 系列產品, 需經濟批量訂購生產。
NKS series are produced by order.

車削型

Needle Roller Bearings

標準式_無內輪

With ribs-without inner ring

NK

NKS

RNA 49

RNA 59

RNA 69



NK(dr≤10)

NK (dr≥12)
NKS ,RNA 49 ,RNA 59
RNA 69 (dr≤35)

RNA 69 (dr≥40)

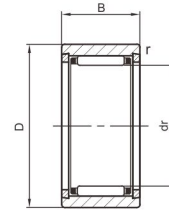
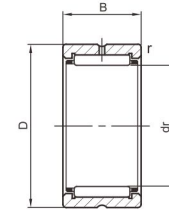
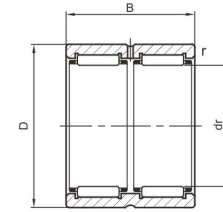
NK ,NKS
(dr≤10mm)NK (dr≥12)
NKS ,RNA 49 ,RNA 59
RNA 69 (dr≤35)
single rowRNA 69
(dr≥40mm)
double row

軸徑 Shaft dia.	軸承型號 Series					單位重 Weight	
	mm	NK	NKS	RNA 49	RNA 59		RNA 69
75		NK 75/25					345
		NK 75/35					485
			NKS 75				402
80		NK 80/25					315
		NK 80/35					445
			NKS 80				413
				RNA 4914			495
					RNA 5914		706
						RNA 6914	910
85		NK 85/25					435
				RNA 4915			525
		NK 85/35					610
					RNA 5915		745
						RNA 6915	960

(1)除了標準的型號之外,SYI亦接受訂製特殊的尺寸規格,特殊型號標示為NK dr x D x B例如NK15x23x12.
Other than the series shown above, custom-made orders are available according to the series number NK dr x D x B.

(2)當使用油脂潤滑時,極限回轉速為表列數值的60%.
With grease lubrication, 60% of the values given in the tables are permissible.

尺寸 Dimensions mm				基本額定負荷 Basic load ratings		極限回轉速 Limited Speed
dr	D	B	r	動 Dynamic C	靜 Static Co	機油潤滑 Oil rpm (2)
			min.	kgf	kgf	
75	92	25	1	6270	13600	5500
75	92	35	1	8680	20700	5500
75	95	28	1.1	7710	14200	5500
80	95	25	1	6530	14400	5000
80	95	35	1	9030	21900	5000
80	100	28	1.1	7880	15300	5000
80	100	30	1	9120	18400	5000
80	100	40	1	12110	24200	5000
80	100	54	1	14400	30700	5000
85	105	25	1	7770	15100	4500
85	105	30	1	10200	19800	4500
85	105	35	1	10700	22900	4500
85	105	40	1	11600	24900	4500
85	105	54	1	15200	33000	4500

(3)外徑尺寸 > 100mm以上者,需經濟批量訂購生產。
The out dimensions > 100mm are produced by order.

(4)NKS 系列產品, 需經濟批量訂購生產。
NKS series are produced by order.

車削型

Needle Roller Bearings

標準式_無內輪

With ribs-without inner ring

NK

NKS

RNA 49

RNA 59

RNA 69



NK(dr≤10)

NK (dr≥12)
NKS ,RNA 49 ,RNA 59
RNA 69 (dr≤35)

RNA 69 (dr≥40)

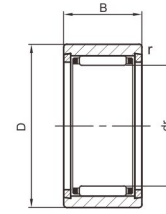
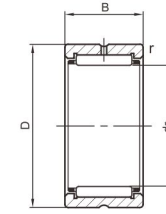
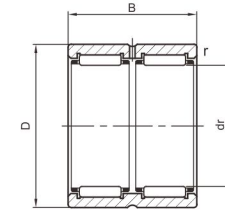
NK ,NKS
(dr≤10mm)NK (dr≥12)
NKS ,RNA 49 ,RNA 59
RNA 69 (dr≤35)
single rowRNA 69
(dr≥40mm)
double row

軸徑 Shaft dia.	軸承型號 Series					單位重 Weight
	mm	NK	NKS	RNA 49	RNA 59	
90	NK 90/25					456
				RNA 4916		550
	NK 90/35					640
					RNA 5916	787
						RNA 6916
95	NK 95/26					495
	NK 95/36					690
100	NK 100/26					525
				RNA 4917		705
	NK 100/36					725
						RNA 6917
105	NK 105/26					545
				RNA 4918		740
	NK 105/36					760
						RNA 6918

(1)除了標準的型號之外,SYI亦接受訂製特殊的尺寸規格,特殊型號標示為NK dr x D x B例如NK15x23x12.
Other than the series shown above, custom-made orders are available according to the series number NK dr x D x B.

(2)當使用油脂潤滑時,極限回轉速為表列數值的60%.
With grease lubrication, 60% of the values given in the tables are permissible.

尺寸 Dimensions mm				基本額定負荷 Basic load ratings		極限回轉速 Limited Speed
dr	D	B	r	動 Dynamic C kgf	靜 Static Co kgf	機油潤滑 Oil rpm (2)
90	110	25	1	8140	16100	4400
90	110	30	1	10100	20500	4400
90	110	35	1	9740	20300	4400
90	110	40	1	11700	25700	4400
90	110	54	1	15100	34300	4400
95	115	26	1	8200	17100	4200
95	115	36	1	11300	26000	4200
100	120	26	1	8550	18100	4000
100	120	35	1.1	9070	18000	4000
100	120	36	1	11800	27600	4000
100	120	63	1.1	18000	43400	4000
105	125	26	1	8890	19200	3800
105	125	35	1.1	12600	29000	3800
105	125	36	1	12300	29100	3800
105	125	63	1.1	18100	46100	3800

(3)外徑尺寸 > 100mm以上者,需經濟批量訂購生產。
The out dimensions > 100mm are produced by order.

(4)NKS 系列產品, 需經濟批量訂購生產。
NKS series are produced by order.

車削型

Needle Roller Bearings

標準式_無內輪

With ribs-without inner ring

NK

NKS

RNA 49

RNA 59

RNA 69



NK(dr≤10)



NK (dr≥12)
NKS ,RNA 49 ,RNA 59
RNA 69 (dr≤35)



RNA 69 (dr≥40)

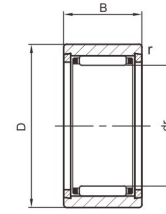

NK ,NKS
(dr≤10mm)

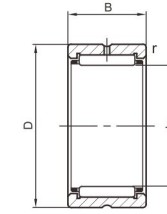

NK (dr≥12)
NKS ,RNA 49 ,RNA 59
RNA 69 (dr≤35)
single row

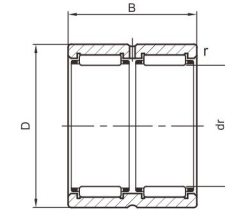

RNA 69
(dr≥40mm)
double row

軸徑 Shaft dia.	軸承型號 Series					單位重 Weight	
	mm	NK	NKS	RNA 49	RNA 59		RNA 69
110		NK 110/30					660
				RNA 4919			770
		NK 110/40					880
						RNA 6919	1420

(1)除了標準的型號之外,SYI亦接受訂製特殊的尺寸規格,特殊型號標示為NK dr x D x B例如NK15x23x12.
Other than the series shown above, custom-made orders are available according to the series number NK dr x D x B.

(2)當使用油脂潤滑時,極限回轉速為表列數值的60%.
With grease lubrication, 60% of the values given in the tables are permissible.

尺寸 Dimensions mm				基本額定負荷 Basic load ratings		極限回轉速 Limited Speed
dr	D	B	r	動 Dynamic C	靜 Static Co	機油潤滑 Oil
			min.	kgf	kgf	rpm (2)
110	130	30	1.1	9780	21800	3600
110	130	35	1.1	13100	30700	3600
110	130	40	1.1	12500	29900	3600
110	130	63	1.1	18900	48800	3600

(3)外徑尺寸 > 100mm以上者,需經濟批量訂購生產。
The out dimensions > 100mm are produced by order.

(4)NKS 系列產品, 需經濟批量訂購生產。
NKS series are produced by order.