

車削型

Needle Roller Bearings

密封式_無內輪

With seals-without inner ring

RNA 49...2RS

RNA 69...2RS



RNA49...2RS
RNA69...2RS
(Fw≤35)



RNA69...2RS
(Fw≥40)

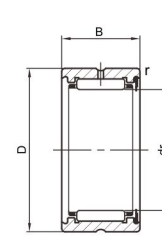

RNA49...2RS

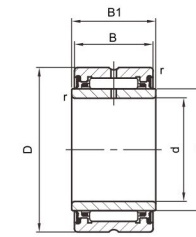

RNA69...2RS

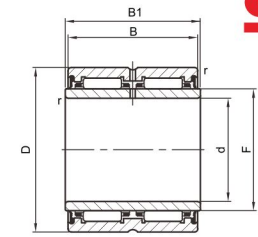

RNA69...2RS(F≥40)

軸徑 Shaft dia.	軸承型號 Series		單位重 Weight
mm	RNA 49...2RS	RNA 69...2RS	g
14	RNA 4900 2RS	—	16
	—	—	—
16	RNA 4901 2RS	—	18
	—	RNA 6901 2RS	30
20	RNA 4902 2RS	—	22
	—	RNA 6902 2RS	38
22	RNA 4903 2RS	—	23
	—	RNA 6903 2RS	40
25	RNA 4904 2RS	—	55
	—	RNA 6904 2RS	96
30	RNA 4905 2RS	—	63
	—	RNA 6905 2RS	110
35	RNA 4906 2RS	—	71
	—	RNA 6906 2RS	130
42	RNA 4907 2RS	—	110
	—	RNA 6907 2RS	200

(1)極限回轉速亦適用於機油潤滑。

Oil lubrication can be applied to increase the speed limit.

(2)RNA69...2RS需經濟批量訂購生產

RNA69...2RS series are produced by order.

尺寸 Dimensions mm				基本額定負荷 Basic load ratings		極限回轉速 Limited Speed
dr	D	B	r	動 Dynamic C	靜 Static Co	油脂潤滑 Grease rpm (1)
14	22	13	0.3	870	930	14000
—	—	—	—	—	—	—
16	24	13	0.3	910	1020	13000
16	24	22	0.3	1560	2040	13000
20	28	13	0.3	1030	1270	10000
20	28	23	0.3	1840	2710	10000
22	30	13	0.3	1100	1440	9000
22	30	23	0.3	1980	3060	9000
25	37	17	0.3	1920	2230	8000
25	37	30	0.3	3300	4450	8000
30	42	17	0.3	2090	2610	6500
30	42	30	0.3	3920	5860	6500
35	47	17	0.3	2250	2990	5500
35	47	30	0.3	4010	6310	5500
42	55	20	0.6	2800	4260	4800
42	55	36	0.6	5160	9260	4800

車削型

Needle Roller Bearings

密封式_無內輪

With seals-without inner ring

RNA 49...2RS

RNA 69...2RS



RNA49...2RS
RNA69...2RS
(Fw≤35)



RNA69...2RS
(Fw≥40)

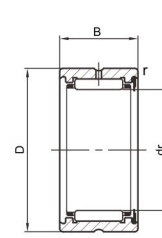

RNA49...2RS

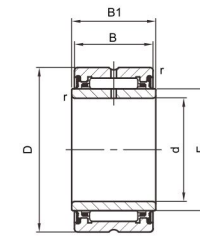

RNA69...2RS

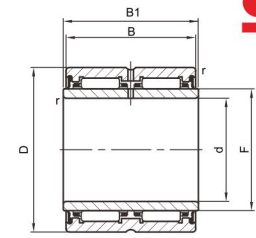

RNA69...2RS(F≥40)

軸徑 Shaft dia.	軸承型號 Series		單位重 Weight
mm	RNA 49...2RS	RNA 69...2RS	g
48	RNA 4908 2RS		150
		RNA 6908 2RS	270
52	RNA 4909 2RS		190
		RNA 6909 2RS	355
58	RNA 4910 2RS		180
		RNA 6910 2RS	320

尺寸 Dimensions mm				基本額定負荷 Basic load ratings		極限回轉速 Limited Speed
dr	D	B	r	動 Dynamic C kgf	靜 Static Co kgf	油脂潤滑 Grease rpm (1)
48	62	22	0.6	3720	5900	4200
48	62	40	0.6	6370	11670	4200
52	68	22	0.6	3740	6180	3800
52	68	40	0.6	6670	12650	3800
58	72	22	0.6	4070	6980	3400
58	72	40	0.6	7080	14220	3400

(1)極限回轉速亦適用於機油潤滑。

Oil lubrication can be applied to increase the speed limit.

(2)RNA69...2RS需經濟批量訂購生產

RNA69...2RS series are produced by order.

車削型

Needle Roller Bearings

密封式_有內輪

With seals-with inner ring

NA 49...2RS

NA 69...2RS



NA49...2RS
NA69...2RS
(Fw≤35)



NA69...2RS
(Fw≥40)

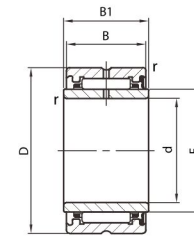

NA49...2RS

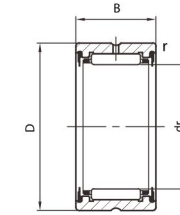

NA69...2RS

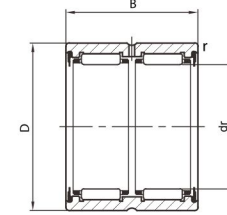

NA69...2RS(F≥40)

軸徑 Shaft dia.	軸承型號 Series		單位重 Weight
mm	NA 49...2RS	NA69...2RS	g
10	NA 4900 2RS	—	25
	—	—	—
12	NA 4901 2RS	—	28
	—	NA 6901 2RS	46
15	NA 4902 2RS	—	36
	—	NA 6902 2RS	63
17	NA 4903 2RS	—	40
	—	NA 6903 2RS	69
20	NA 4904 2RS	—	78
	—	NA 6904 2RS	140
25	NA 4905 2RS	—	93
	—	NA 6905 2RS	162
30	NA 4906 2RS	—	106
	—	NA 6906 2RS	185
35	NA 4907 2RS	—	179
	—	NA 6907 2RS	320

* 內輪附有油孔。

* Lubrication hole is in the inner ring.

(1) 極限回轉速亦適用於機油潤滑。

Oil lubrication can be applied to increase the speed limit.

(2) NA69...2RS需經濟批量訂購生產

NA69...2RS series are produced by order.

尺寸 Dimensions mm						基本額定負荷 Basic load ratings		極限回轉速 Limited Speed
d	F	D	B	B1	r min.	動 Dynamic C kgf	靜 Static Co kgf	油脂潤滑 Grease rpm (1)
10	14	22	13	14	0.3	870	930	14000
—	—	—	—	—	—	—	—	—
12	16	24	13	14	0.3	910	1020	13000
12	16	24	22	23	0.3	1560	2040	13000
15	20	28	13	14	0.3	1030	1270	10000
15	20	28	23	14	0.3	1840	2710	10000
17	22	30	13	14	0.3	1100	1440	9000
17	22	30	23	14	0.3	1980	3060	9000
20	25	37	17	18	0.3	1920	2230	8000
20	25	37	30	31	0.3	3300	4450	8000
25	30	42	17	18	0.3	2090	2610	6500
25	30	42	30	31	0.3	3920	5860	6500
30	35	47	17	18	0.3	2250	2990	5500
30	35	47	30	31	0.3	4010	6310	5500
35	42	55	20	21	0.6	2800	4260	4800
35	42	55	36	37	0.3	5160	9260	4800

車削型

Needle Roller Bearings

密封式_有內輪

With seals-with inner ring

NA 49...2RS

NA 69...2RS



NA49...2RS
NA69...2RS
(Fw≤35)



NA69...2RS
(Fw≥40)

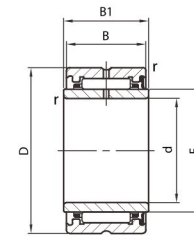

NA49...2RS

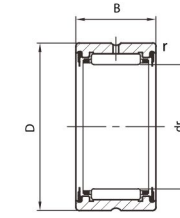

NA69...2RS

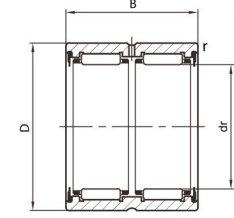

NA69...2RS(F≥40)

軸徑 Shaft dia.	軸承型號 Series		單位重 Weight
mm	NA 49...2RS	NA69...2RS	g
40	NA 4908 2RS		245
		NA 6908 2RS	440
45	NA 4909 2RS		290
		NA 6909 2RS	510
50	NA 4910 2RS		300
		NA 6910 2RS	530

* 內輪附有油孔。

* Lubrication hole is in the inner ring.

(1)極限回轉速亦適用於機油潤滑。

Oil lubrication can be applied to increase the speed limit.

(2)NA69...2RS需經濟批量訂購生產

NA69...2RS series are produced by order.

尺寸 Dimensions mm						基本額定負荷 Basic load ratings		極限回轉速 Limited Speed
d	F	D	B	B1	r min.	動 Dynamic C kgf	靜 Static Co kgf	油脂潤滑 Grease rpm (1)
40	48	62	22	23	0.6	3720	5900	4200
40	48	62	40	41	0.6	6330	11670	4200
45	52	68	22	23	0.6	3740	6180	3800
45	52	68	40	41	0.6	6670	12650	3800
50	58	72	22	23	0.6	4070	6980	3400
50	58	72	40	41	0.6	7080	14220	3400