

Anwenderhinweise  
Technische Information

DE

User Manual  
Technical Information

EN

Mode d'emploi  
Informations techniques

FR

Manual del usuario  
Información técnica





ES

Istruzioni per l'uso  
Informazioni tecniche

IT



## Product Specification

Product	automatic long-term grease and oil dispenser			
Power generation	hydrogen gas producing drycells			
Working pressure	max. 5 bar			
Adjustment	stepless 1–12 months (for standard conditions)			
Dispensing rate	see table on page 15–17			
Operating temperature	–20°C to +55°C (–4°F to +131°F) ambient temperature (Note: grease consistency changes with temperature)			
Operation/Usage	Grease dispenser can be installed in any position, even under water. Attention: do not expose to direct heat.			
Certifications/Approvals	   II 1G Ex ia IIC T6 II 1D Ex iaD 20T 80°C I M1 Ex ia I 			
Ingress protection	IP68 (dustproof and waterproof)			
Usage period	within 2 years of production date			
Stock temperature	recommended at 20°C ± 5°C (65°F ± 5°F)			
	<b>30 ml</b>	<b>60 ml</b>	<b>125 ml</b>	<b>250 ml</b>
Weight full	~ 82 g	~ 115g	~ 190 g	~ 335 g
Weight empty	~ 55 g	~ 60 g	~ 75 g	~ 111 g

**simalube 30**



**simalube 60**



**simalube 125**



**simalube 250**



## Assembly and Installation

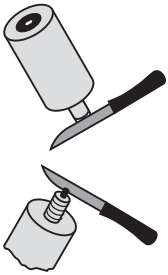

- 1) Open the lubricator outlet by cutting off seal or removing plug.

**Do not remove plug from oil filled units!** Cut off the protruding nipple with a knife; a small black point becomes visible (opening now guaranteed).



- 2) To start the simalube lubricator, set the gas generator to the required dispensing time (stepless in months, 1–12) using a 3 mm Allen key. The lubricator is activated once the dispensing time has been set. Take the required dispensing quantity from the tables on page 16.

- 3) Note the starting date on the label using a waterproof pen.



- 4) Clear grease lines and fill them with the appropriate grease. Screw simalube onto the greasing point. If necessary, use accessories shown on page 20–22. Apply safety rules.
- 5) Once the set dispensing time has expired, replace empty lubricator with the same type or refill. Before restarting, clear grease lines and fill them with the appropriate grease.
- 6) The gas generator is sufficient to empty the unit **once, irrespective of the dispensing time set.**

**Security note:** If the lubricator is started without opening the outlet or in case of blocked grease lines within the installation, the pressure in the lubricator can build up approx. 5 bar. At an overpressure of approx. 6 bar the lubricator breaks at the defined breaking point between housing and bottom. The pressure behind the piston releases and oil or grease can come out at the breaking point.

The correct functioning of the lubricator can only be assured if recommended lubricants (see table on page 19) and original simalube accessories are used, and if the installation, operating and maintenance instructions are closely followed. The manufacturer cannot accept any responsibility for damages as a result of ignoring the instructions mentioned above. Important: Before putting simalube into operation fill extensions and the lubrication lines with the appropriate simalube greases (cartouches KAO ...KA25) using a grease gun. Use only original accessories.

## Temperature / Output rate

The output rate can be adjusted as required, depending on the ambient temperature (see table).

**Example:** You want to set the dispensing time for a 125 ml simalube for 180 days.  
 Ambient temperature: 20°C      Ambient temperature: 55°C  
 Setting: 6      Setting: 7



**simalube 30**

Dispensing time (days)	30	90	180	270	360
ml/day	1.00	0.33	0.17	0.11	0.08
Temperature	Setting	Setting	Setting	Setting	Setting
-20°C	+	2	3.5	5.5	7.5
4°C	+	2.5	5	7.5	10.5
<b>20°C</b>	<b>1</b>	<b>3</b>	<b>6</b>	<b>9</b>	<b>12</b>
40°C	1	3	6.5	9.5	-
55°C	1	3.5	7	10.5	-

- + use larger dispenser with longer dispensing time
- smallest possible output rate reached

**simalube 60**

Dispensing time (days)	30	90	180	270	360
ml/day	2.00	0.67	0.33	0.22	0.17
Temperature	Setting	Setting	Setting	Setting	Setting
-20°C	+	2	4	6.5	8
4°C	+	2.5	5.5	9	10.5
<b>20°C</b>	<b>1</b>	<b>3</b>	<b>6</b>	<b>9</b>	<b>12</b>
40°C	1	3	6.5	9.5	-
55°C	1	3.5	7	10.5	-

- + use larger dispenser with longer dispensing time
- smallest possible output rate reached

**simalube 125**

Dispensing time (days)	30	90	180	270	360
ml/day	4.17	1.39	0.69	0.46	0.35
Temperature	Setting	Setting	Setting	Setting	Setting
-20°C	+	2	4	6.5	8.5
4°C	+	2.5	5.5	8	10.5
<b>20°C</b>	<b>1</b>	<b>3</b>	<b>6</b>	<b>9</b>	<b>12</b>
40°C	1	3	6.5	9.5	-
55°C	1	3.5	7	10	-

- + use larger dispenser with longer dispensing time
- smallest possible output rate reached

**simalube 250**

Dispensing time (days)	30	90	180	270	360
ml/day	8.33	2.78	1.39	0.93	0.69
Temperature	Setting	Setting	Setting	Setting	Setting
-20°C	++	2	4.5	7.5	9.5
4°C	++	2.5	5.5	8	10.5
<b>20°C</b>	<b>1</b>	<b>3</b>	<b>6</b>	<b>9</b>	<b>12</b>
40°C	1	3	6	9	-
55°C	1	3.5	6.5	9.5	-

- ++ use 2-fold adapter
- use smaller dispenser with shorter dispensing time

The values relate to laboratory conditions, SL01 with no counterpressure. At low temperatures in particular, the values may vary between one grease type and another. The dispensers must be replaced once the dispensing time set has expired, even if they are not completely empty.

The grease quantity dispensed per day is influenced by:

- counter pressure/resistance from the grease lines
- ambient temperature
- viscosity of the grease

### Start-up time:

The lubricator requires a certain start-up time until the lubricant is first dispensed. The start-up time varies in line with the volume dispensed, dispenser size and operating temperature selected. At 20°C ambient temperature and a dispensing time setting of 12 months, the dispenser outputs the lubricant within one week. The start-up time doubles at low temperatures (–20°C) or with small dispensers (30 ml).

You can reduce the start-up time in such a case by setting a dispensing time on the lubricator of one month for one to two days and then changing to the desired dispensing time.

### Calculation Pro:

An online calculation program is available at [www.simatec.com](http://www.simatec.com) (simalube/calculation pro). This tool calculates the right setting for the simalube lubricator if you enter the precise operating parameters.

### Notes:

In order for the unit to function reliably, it is important to have clear, filled grease lines. It must be ensured that the grease lines are not blocked. Consequently, the grease lines should always be cleared with a grease gun before starting.

The simalube can be re-adjusted or switched off during operation.

The values on the gas generator relate to laboratory conditions (see page 15). Depending on the temperature and setting, it may take several hours (or several days in the case of long-term settings) until the lubricant is first dispensed.

The user must check the operation of the simalube regularly.

Grease lines should be no longer than 0.5 m. Recommended bore diameter: 6–8 mm. Resistance in grease lines has to be minimized, narrow passages and right angles should be avoided.

Use a mounting support in the event of strong vibrations or high accelerations (for accessories, see page 21).

The simalube may only be used to supply **a single** grease point. No branches may be made.

Once the lubricator is installed and activated, it must not be removed and mounted onto another lubrication point.

## Filling and Refilling (for small quantities)

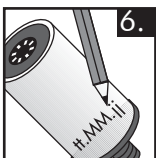
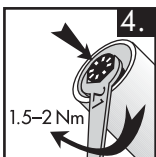
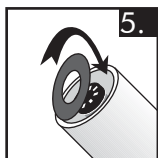
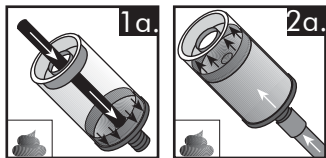

### Filling with grease

1a. Push piston all the way forward by blowing gently with compressed air or with the aid of a plastic rod (7 mm diameter), towards the bottom or opening.

2a. Screw on refill nipple (article no. 3012) and connect grease gun, or screw connector nipple (3013 or 3014) onto grease gun. Keep the dispenser pressed to the adapter during the filling process so that you do not have to screw on the refill nipple again. Press grease into the dispenser. Avoid air bubbles when filling the unit. Continue the filling process until the piston has been pushed all the way back. Do not overfill! **Caution: Lever presses can create pressure of up to 80 bar, which is enough to destroy the dispenser.**

3a. Use closing nipple (green) if the dispenser is to be stored.

4. Position gas generator (make sure the O-ring is positioned correctly) and attach firmly with a 1.5–2.0 Nm torque key.

5. Clip in cover disk.

6. Note grease type and filling date on the label.

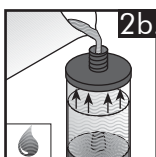
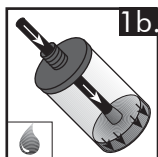

### Filling with oil

1b. Push the piston all the way back (towards the gas generator).

2b. Pour in oil through the opening at the bottom.

3b. Position non-return valve (yellow, article no. 5060).

4–6 Continue as above.

### Refilling with grease or oil

1. Remove cover disk.

2. Unscrew gas generator (SW 21) and recycle with other batteries. Never remove near an open flame! Then continue as above for filling with grease or oil.

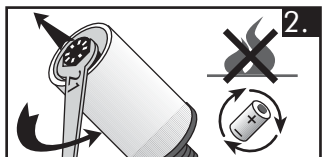
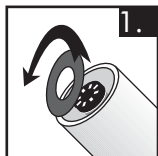

### Note

To ensure that the simalube lubricator operates reliably, only greases that have been tested and approved for use with the simalube should be used. In particular, it is important to ensure the good stability of the grease against bleeding of the base oil and a low consistency class (max. NLGI 2). No guarantee claims will be accepted when dispensers are filled by the user or not explicitly approved lubricants are used. If in doubt, please contact our Technical Department or your local distributor.

## Lubricants

The standard lubricant range suitable for simalube includes modern high quality lubricants tested and modified for the special requirements of grease and oil dispensers. Datasheets are available online for all lubricants ([www.simatec.com](http://www.simatec.com)). Please refer to these datasheets for the instructions/safety regulations of the grease/oil manufacturers.

No.	Application	Temperature range (in the area of lubrication)
<b>SL01</b>	Multipurpose grease	-30/+120°C
<b>SL02</b>	Multipurpose grease with MoS <sub>2</sub>	-25/+130°C
<b>SL04</b>	High temperature grease	-20/+160°C
<b>SL06</b>	Fluid grease	-20/+120°C
<b>SL09</b>	Biodegradable grease	-20/+80/100°C
<b>SL10</b>	Food industry grease (NSF H1)	-30/+140°C
<b>SL14</b>	Chain oil	-10/+90°C
<b>SL15</b>	High temperature chain oil	0/+250°C
<b>SL18</b>	Food industry oil (NSF H1)	-15/+150°C
<b>SL24</b>	Grease for a wide temperature range	-30/+150°C
<b>SL25</b>	High temperature grease	-20/+180°C

simalube can also be delivered filled with other lubricants or as an empty unit. Ask for advice. The operation of simalube with oils of different viscosities is also possible.





## Troubleshooting

Fault	Possible cause	Remedy
- no grease output	<ul style="list-style-type: none"> <li>- seal not cut off/closing nipple still in place</li> <li>- not switched on</li> <li>- grease lines blocked</li> <li>- gas generator loose</li> </ul>	<ul style="list-style-type: none"> <li>- open/remove</li> <li>- switch on</li> <li>- clear lines with grease gun</li> <li>- tighten with 2 Nm</li> </ul>
- insufficient output	<ul style="list-style-type: none"> <li>- dispensing time too long</li> <li>- ambient temperature too low</li> <li>- grease lines blocked/too narrow</li> <li>- short-term extreme low temperatures, piston moves backwards</li> <li>- high counter pressure</li> </ul>	<ul style="list-style-type: none"> <li>- set to lower number</li> <li>- correct setting according to table, page 16</li> <li>- clean, allow for free flow of grease</li> <li>- none</li> <li>- clear grease lines, check installation</li> </ul>
- excessive output	<ul style="list-style-type: none"> <li>- dispensing time too short</li> </ul>	<ul style="list-style-type: none"> <li>- set to higher number</li> </ul>

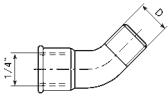
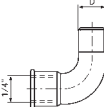
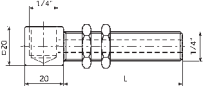
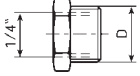
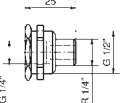

For other malfunctions contact simatec engineering or your local distributor. The information provided reflects the manufacturer's current level of development and understanding. Subject to change. The products are subject to strict manufacturing controls and meet internal works specifications. As a result of the wide range of conditions and areas of application possible in each case, no guarantee can be provided for effectiveness or success in each individual instance. No responsibility is accepted for damage or malfunctions caused by incorrect use or improper work on or with the lubricator.

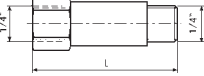

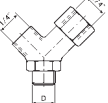
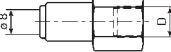
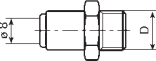

## Accessories

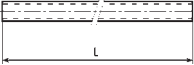
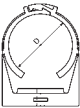
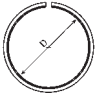
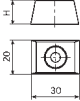

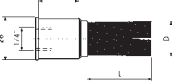
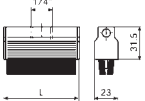
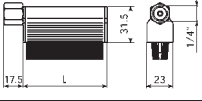
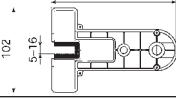
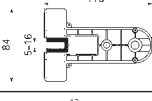
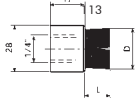
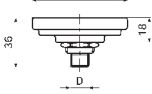
**Note:** Use only original accessories. If you have technically demanding or unusual applications, please contact our Technical Department or your local distributor.

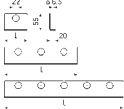
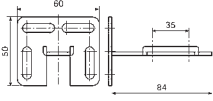
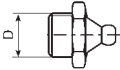
	<p><b>Bent connection 45°</b></p> <table border="1"> <tr> <td><b>D</b></td> <td>R 1/4</td> </tr> <tr> <td><b>Nr.</b></td> <td>1001</td> </tr> </table>	<b>D</b>	R 1/4	<b>Nr.</b>	1001																		
<b>D</b>	R 1/4																						
<b>Nr.</b>	1001																						
	<p><b>Bent connection 90°</b></p> <table border="1"> <tr> <td><b>D</b></td> <td>R 1/4</td> </tr> <tr> <td><b>Nr.</b></td> <td>1002</td> </tr> </table>	<b>D</b>	R 1/4	<b>Nr.</b>	1002																		
<b>D</b>	R 1/4																						
<b>Nr.</b>	1002																						
	<p><b>90° connection with thread</b> (only for oil) 70 mm incl. 2 nuts</p> <table border="1"> <tr> <td><b>L</b></td> <td>70</td> <td>[ mm ]</td> </tr> <tr> <td><b>Nr.</b></td> <td>1005</td> <td></td> </tr> </table>	<b>L</b>	70	[ mm ]	<b>Nr.</b>	1005																	
<b>L</b>	70	[ mm ]																					
<b>Nr.</b>	1005																						
	<p><b>Connecting nipple</b></p> <table border="1"> <tr> <td><b>D</b></td> <td>R 3/8</td> <td>R 1/2</td> </tr> <tr> <td><b>Nr.</b></td> <td>1010</td> <td>1011</td> </tr> </table>	<b>D</b>	R 3/8	R 1/2	<b>Nr.</b>	1010	1011																
<b>D</b>	R 3/8	R 1/2																					
<b>Nr.</b>	1010	1011																					
	<p><b>Fixation nipple G 1/2"-R 1/4"</b></p> <table border="1"> <tr> <td><b>L</b></td> <td>25</td> <td>[ mm ]</td> </tr> <tr> <td><b>Nr.</b></td> <td>1015</td> <td></td> </tr> </table>	<b>L</b>	25	[ mm ]	<b>Nr.</b>	1015																	
<b>L</b>	25	[ mm ]																					
<b>Nr.</b>	1015																						
	<p><b>Reducing nipple</b></p> <table border="1"> <tr> <td><b>D</b></td> <td>R 1/8</td> <td>R 1/4</td> <td>M6</td> <td>M8</td> <td>M8x1</td> <td>M10</td> <td>M10x1</td> <td>M12</td> <td>M12x1.5</td> <td>UNF 1/4</td> </tr> <tr> <td><b>Nr.</b></td> <td>1020</td> <td>1021</td> <td>1022</td> <td>1023</td> <td>1024</td> <td>1025</td> <td>1026</td> <td>1027</td> <td>1028</td> <td>1121</td> </tr> </table>	<b>D</b>	R 1/8	R 1/4	M6	M8	M8x1	M10	M10x1	M12	M12x1.5	UNF 1/4	<b>Nr.</b>	1020	1021	1022	1023	1024	1025	1026	1027	1028	1121
<b>D</b>	R 1/8	R 1/4	M6	M8	M8x1	M10	M10x1	M12	M12x1.5	UNF 1/4													
<b>Nr.</b>	1020	1021	1022	1023	1024	1025	1026	1027	1028	1121													
	<p><b>Extension</b></p> <table border="1"> <tr> <td><b>L</b></td> <td>10</td> <td>35</td> <td>50</td> <td>[ mm ]</td> </tr> <tr> <td><b>Nr.</b></td> <td>1021</td> <td>1040</td> <td>1041</td> <td></td> </tr> </table>	<b>L</b>	10	35	50	[ mm ]	<b>Nr.</b>	1021	1040	1041													
<b>L</b>	10	35	50	[ mm ]																			
<b>Nr.</b>	1021	1040	1041																				
	<p><b>Screwed connection with hole</b> 25 mm incl. 1 nut</p> <table border="1"> <tr> <td><b>L</b></td> <td>25</td> <td>60</td> <td>[ mm ]</td> </tr> <tr> <td><b>Nr.</b></td> <td>1045</td> <td>1046</td> <td></td> </tr> </table>	<b>L</b>	25	60	[ mm ]	<b>Nr.</b>	1045	1046															
<b>L</b>	25	60	[ mm ]																				
<b>Nr.</b>	1045	1046																					
	<p><b>Y-manifold</b> Contains reduction 1021</p> <table border="1"> <tr> <td><b>D</b></td> <td>R 1/4</td> </tr> <tr> <td><b>Nr.</b></td> <td>1050</td> </tr> </table>	<b>D</b>	R 1/4	<b>Nr.</b>	1050																		
<b>D</b>	R 1/4																						
<b>Nr.</b>	1050																						
	<p><b>Quick connection</b> For hose ø 8 mm</p> <table border="1"> <tr> <td><b>D</b></td> <td>R 1/4</td> </tr> <tr> <td><b>Nr.</b></td> <td>1060</td> </tr> </table>	<b>D</b>	R 1/4	<b>Nr.</b>	1060																		
<b>D</b>	R 1/4																						
<b>Nr.</b>	1060																						
	<p><b>Quick connection</b> For hose ø 8 mm</p> <table border="1"> <tr> <td><b>D</b></td> <td>R 1/8</td> <td>R 1/4</td> <td>R 3/8</td> </tr> <tr> <td><b>Nr.</b></td> <td>1070</td> <td>1071</td> <td>1072</td> </tr> </table>	<b>D</b>	R 1/8	R 1/4	R 3/8	<b>Nr.</b>	1070	1071	1072														
<b>D</b>	R 1/8	R 1/4	R 3/8																				
<b>Nr.</b>	1070	1071	1072																				

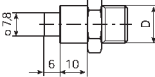
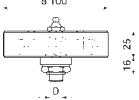
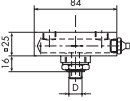
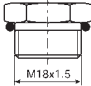
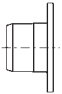

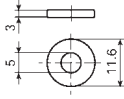
	<p><b>Hose</b> Maximum length to greasing point: 0.5 m /available by the metre</p> <table border="1"> <tr> <td><b>L</b></td> <td colspan="3">per meter</td> </tr> <tr> <td><b>Nr.</b></td> <td colspan="3">2000/...m</td> </tr> </table>	<b>L</b>	per meter			<b>Nr.</b>	2000/...m								
<b>L</b>	per meter														
<b>Nr.</b>	2000/...m														
	<p><b>Clamp for simalube/round brush</b> Plastic</p> <table border="1"> <tr> <td><b>D</b></td> <td>50</td> <td>28</td> <td></td> <td></td> <td>[ mm ]</td> </tr> <tr> <td><b>Nr.</b></td> <td>2010</td> <td>2013</td> <td></td> <td></td> <td></td> </tr> </table>	<b>D</b>	50	28			[ mm ]	<b>Nr.</b>	2010	2013					
<b>D</b>	50	28			[ mm ]										
<b>Nr.</b>	2010	2013													
	<p><b>Adapter for Perma clamp</b> Plastic</p> <table border="1"> <tr> <td><b>D</b></td> <td>50</td> <td></td> <td></td> <td></td> <td>[ mm ]</td> </tr> <tr> <td><b>Nr.</b></td> <td>2012</td> <td></td> <td></td> <td></td> <td></td> </tr> </table>	<b>D</b>	50				[ mm ]	<b>Nr.</b>	2012						
<b>D</b>	50				[ mm ]										
<b>Nr.</b>	2012														
	<p><b>Distance holder to clamp for round brush (2013)</b></p> <table border="1"> <tr> <td><b>H</b></td> <td>15</td> <td></td> <td></td> <td></td> <td>[ mm ]</td> </tr> <tr> <td><b>Nr.</b></td> <td>2014</td> <td></td> <td></td> <td></td> <td></td> </tr> </table>	<b>H</b>	15				[ mm ]	<b>Nr.</b>	2014						
<b>H</b>	15				[ mm ]										
<b>Nr.</b>	2014														
	<p><b>Non-return valve</b></p> <table border="1"> <tr> <td><b>D</b></td> <td>R 1/8</td> <td>R 1/4</td> <td></td> <td></td> <td></td> </tr> <tr> <td><b>Nr.</b></td> <td>2020</td> <td>2021</td> <td></td> <td></td> <td></td> </tr> </table>	<b>D</b>	R 1/8	R 1/4				<b>Nr.</b>	2020	2021					
<b>D</b>	R 1/8	R 1/4													
<b>Nr.</b>	2020	2021													
	<p><b>Round brush</b> Plastic bristles</p> <table border="1"> <tr> <td><b>DxL</b></td> <td colspan="3">ø 25x45</td> <td></td> <td>[ mm ]</td> </tr> <tr> <td><b>Nr.</b></td> <td>2034</td> <td></td> <td></td> <td></td> <td></td> </tr> </table>	<b>DxL</b>	ø 25x45				[ mm ]	<b>Nr.</b>	2034						
<b>DxL</b>	ø 25x45				[ mm ]										
<b>Nr.</b>	2034														
	<p><b>Brush</b> Horse bristles</p> <table border="1"> <tr> <td><b>L</b></td> <td>40</td> <td>70</td> <td>100</td> <td>25</td> <td></td> <td>[ mm ]</td> </tr> <tr> <td><b>Nr.</b></td> <td>2035</td> <td>2036</td> <td>2037</td> <td>2038</td> <td></td> <td></td> </tr> </table>	<b>L</b>	40	70	100	25		[ mm ]	<b>Nr.</b>	2035	2036	2037	2038		
<b>L</b>	40	70	100	25		[ mm ]									
<b>Nr.</b>	2035	2036	2037	2038											
	<p><b>Brush, lateral connection</b> Horse bristles</p> <table border="1"> <tr> <td><b>L</b></td> <td>40</td> <td>70</td> <td>100</td> <td></td> <td></td> <td>[ mm ]</td> </tr> <tr> <td><b>Nr.</b></td> <td>2035-S</td> <td>2036-S</td> <td>2037-S</td> <td></td> <td></td> <td></td> </tr> </table>	<b>L</b>	40	70	100			[ mm ]	<b>Nr.</b>	2035-S	2036-S	2037-S			
<b>L</b>	40	70	100			[ mm ]									
<b>Nr.</b>	2035-S	2036-S	2037-S												
	<p><b>Elevator brush</b> High 32 mm</p> <table border="1"> <tr> <td><b>Nr.</b></td> <td>2039</td> <td></td> <td></td> <td></td> <td></td> </tr> </table>	<b>Nr.</b>	2039												
<b>Nr.</b>	2039														
	<p><b>Elevator brush small</b> High 32 mm</p> <table border="1"> <tr> <td><b>Nr.</b></td> <td>2042</td> <td></td> <td></td> <td></td> <td></td> </tr> </table>	<b>Nr.</b>	2042												
<b>Nr.</b>	2042														
	<p><b>Round brush</b> Horse bristles</p> <table border="1"> <tr> <td><b>DxL</b></td> <td colspan="3">ø 25x15</td> <td></td> <td>[ mm ]</td> </tr> <tr> <td><b>Nr.</b></td> <td>2041</td> <td></td> <td></td> <td></td> <td></td> </tr> </table>	<b>DxL</b>	ø 25x15				[ mm ]	<b>Nr.</b>	2041						
<b>DxL</b>	ø 25x15				[ mm ]										
<b>Nr.</b>	2041														
	<p><b>Mounting support for all simalube sizes</b></p> <table border="1"> <tr> <td><b>Nr.</b></td> <td>2080</td> <td></td> <td></td> <td></td> <td></td> </tr> </table>	<b>Nr.</b>	2080												
<b>Nr.</b>	2080														

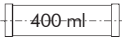
	<p><b>Protective cover to mounting support 2080</b> (steel) (for simalube 125 ml or smaller)</p> <p>Nr.   2081</p>				
	<p><b>Bracket to mounting support</b></p> <table border="1" data-bbox="355 380 974 414"> <tr> <td>1-fold length 75 mm</td> <td>3-fold length 240 mm</td> <td>5-fold length 390 mm</td> </tr> </table> <p>Nr.   2082   2083   2084</p>	1-fold length 75 mm	3-fold length 240 mm	5-fold length 390 mm	
1-fold length 75 mm	3-fold length 240 mm	5-fold length 390 mm			
	<p><b>Bracket, universally adjustable</b></p> <p>Nr.   2800</p>				
	<p><b>Connector nipple</b> For cleaning and filling of grease lines</p> <p>D   R 1/4</p> <p>Nr.   3011</p>				
	<p><b>Refill nipple</b> For refilling of simalube</p> <p>D   R 1/4</p> <p>Nr.   3012</p>				
	<p><b>Connecting nipple</b> To grease gun filler for filling simalube</p> <p>D   R 1/4   R 3/8</p> <p>Nr.   3013   3014</p>				
	<p><b>4-fold adapter</b></p> <p>D   R 1/2   R 1/4</p> <p>Nr.   4100   4101</p>				
	<p><b>2-fold adapter</b></p> <p>D   R 1/2   R 1/4</p> <p>Nr.   4102   4103</p>				
	<p><b>Gas generator</b> For refilling</p> <table border="1" data-bbox="355 1434 974 1490"> <tr> <td>30 ml</td> <td>60 ml</td> <td>125 ml</td> <td>250 ml</td> </tr> </table> <p>Nr.   5004   5006   5008   5010</p>	30 ml	60 ml	125 ml	250 ml
30 ml	60 ml	125 ml	250 ml		
	<p><b>Closing nipple</b> Plastic</p> <p>Nr.   5050</p>				
	<p><b>Non-return valve plug</b> Plastic</p> <p>Nr.   5060</p>				
	<p><b>Gasket ring</b></p> <p>Nr.   5080</p>				

	<b>Grease cartridge</b>									
	<b>Grease</b>	SL01	SL02	SL04	SL06	SL09	SL10	SL24	SL25	
	<b>Nr.</b>	KA01	KA02	KA04	KA06	KA09	KA10	KA24	KA25	
	<b>Oil bottle, 0.5l</b>									
	Chain oil							OF14		
	High temperature chain oil							OF15		
	Food industry oil							OF18		

## Recycling Instructions



- 1) Unscrew gas generator and dispose of complete unit for battery recycling (see above). **Note:** Do not detach lubricator near an open flame.
- 2) Dispose of empty housing for PET recycling. If the lubricator still contains lubricant after use, please dispose of it in accordance with local regulations.

simalube has been safety inspected and approved by the following institutions:

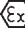
- Physikalisch Technische Bundesanstalt, Brunswick, Germany, Nr. 3.42-16990/94
  - FM Approvals, USA, Project Identification Number: 3013825
  - Technischer Überwachungsverein (TÜV) Rheinland, Cologne, Germany, 12.05.95
  - DMT Gesellschaft für Forschung und Prüfung GmbH, Germany Nr. 16420/344/96
  - LOBA NRW, Dortmund, Germany, Nr. 12.22.63-4-2
  - INERIS, France, Nr. 96.Y.300 X, CROSS ia I
  - EECS / BASEEFA, United Kingdom, No. 95 (A) 0692, 1997-04-10
  - TÜV Product Service GmbH, Germany, Nr. Z1 08 02 29499 015
  - TÜV Product Service GmbH, Germany, Nr. EX3 10 04 29499 016
  - KEMA Quality B.V., Netherland Nr. KEMA 09ATEX0098
- II 1 G Ex ia IIC T6  
 •  II 1 D Ex iaD 20 T 80°C  
 I M1 Ex ia I

### EU Declaration of Conformity

#### simatec ag

Stadthof 2 in CH-3380 Wangen a. Aare  
 declares that the

single point lubricators

#### simalube & simalube multipoint

are designed and manufactured in  
 accordance with

**Directive 94/9/EC of the European  
 Parliament and the Council for equipment  
 and protective systems intended for use in  
 potentially explosive atmospheres.**

The following standards have been applied:

- EN 60079-0:2006**
- EN 60079-11:2007**
- EN 60079-26:2004**
- EN 61241-0:2006**
- EN 61241-11:2006**
- EN 50303:2000**

Notified Body:

**TÜV Product Service GmbH**  
**D-80339 Munich**  
**KEMA Quality B.V., NL-6812 AR Arnhem**

Certificate No.

**KEMA 09ATEX0098**

Wangen a. Aare, 10.11.11

Mischa Wyssmann, Managing Director CEO

Manufactured by:

#### simatec ag

Stadthof 2, CH-3380 Wangen a. Aare  
 www.simalube.com